

Instructions for Smart Wifi control kit

Wiring electrics

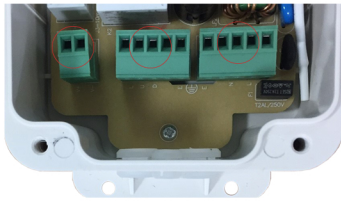

LED Light (Awning)

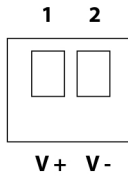

1. V+ = Wire with white line
2. V- = Wire with transparent line

Motor (Awning)

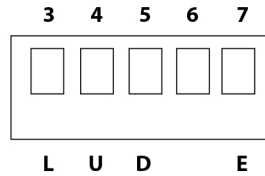

3. L = Blue Wire
4. U = Brown Wire
5. D = Black Wire
6. = No Wire
7. E = Yellow and Green Wire

Mains (Power)

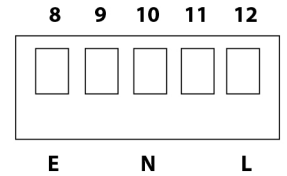

8. E = Yellow and Green Wire
9. = No Wire
10. N = Blue Wire
11. = No Wire
12. L = Brown Wire

Setting up: Remote control

- Press "P2" on top of Wifi box (LED light flashes)
- Press "Stop" on top of Wifi box (LED light will flash brighter)
- Press "UP" on remote control zapper
- Device will bleep (Syncing with remote control)
- Setup is now complete

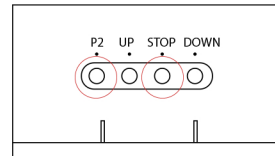

Setting up: Smart device

- Download QR code scanner/reader on APP store
- Open QR reader and scan the correct QR code for Android or Apple device
- Open link in browser, download APP "Awning"

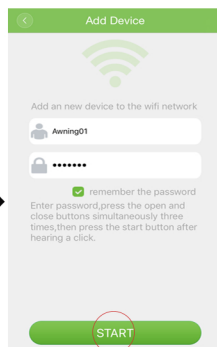
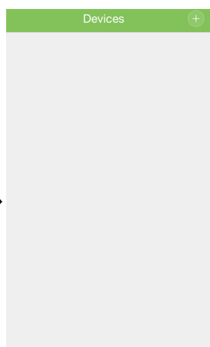
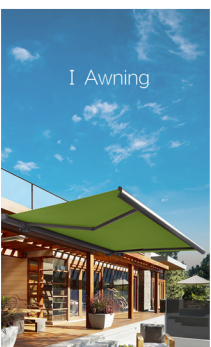
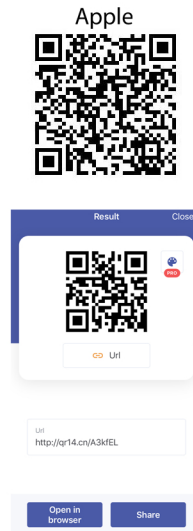
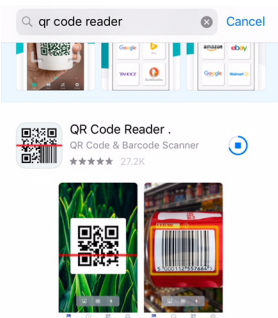

Note: Username and Password needs to be the same details as your Wifi network.

1. Enter Username and Password
2. Press "START" button **first** on the APP
3. Press "UP" and "Down" buttons at the same time (x 3)
4. Smart box will bleep and start connecting
5. Connection complete, click and use your awning

